

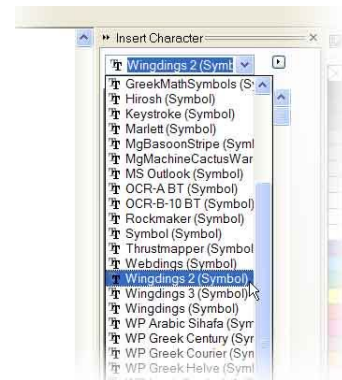

Design a custom Arabesque!

Using simple techniques design an arabesque that can be converted to fancy Embroidery!

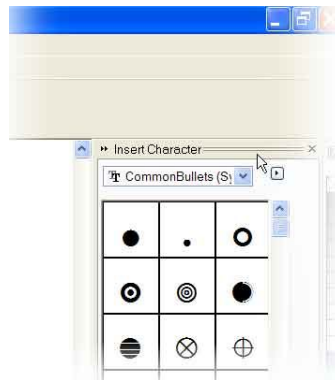

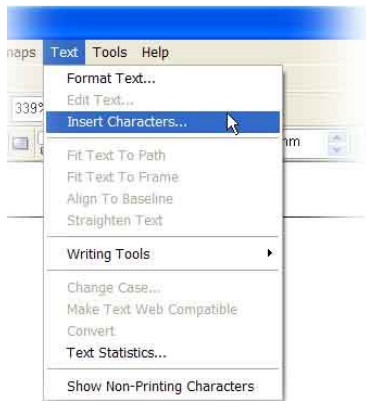
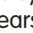
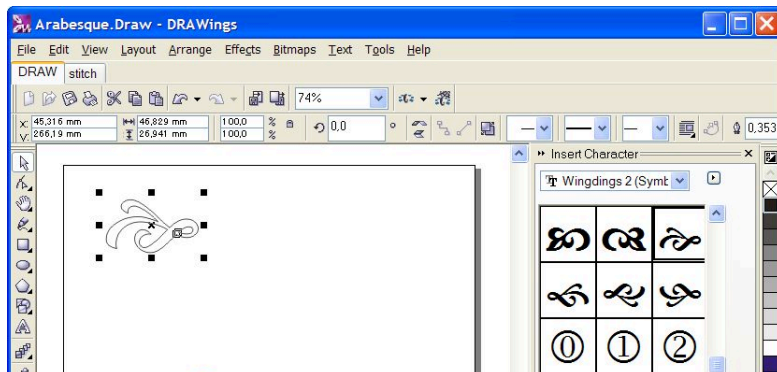

1. On a new design in **CorelDRAW** click on **Text** menu then click **Insert Characters...**
2. You'll notice a Docker opened named **Insert Character** on the right side of the design area.
3. From the drop down menu select the font symbol **Wingdings2**. Then scroll down the symbols till the  symbol appears.

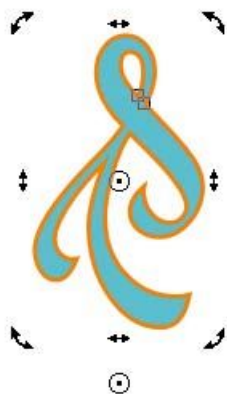

4. Drag the symbol holding the left mouse button and drop it in the design area. On the Property Bar locate **Angle of Rotation**  and type **90**. This will rotate the symbol to help us proceed with the arabesque.
5. Color the symbol as you like and also change the thickness of the outline to let **DRAWings** figure out the application of **Running** and **Satin** type stitches.

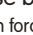

6. Double click on the design to let the rotation handles appear and move the rotation anchor point  a bit lower than the symbol. (This will be the center of the rotation procedure and the exact placement is important).
7. Hold down the **Ctrl** key and rotate 45°, clockwise by clicking on the right upper rotation arrow . (Holding Ctrl key down forces 15° rotation steps) Now, on the **Angle of Rotation** mentioned above wait to see the 45° degree and then hit the **RIGHT** mouse button once; the cursor will change to . Release the mouse. Holding the **Ctrl** key pressed, press the **R** key (Repeat last command).

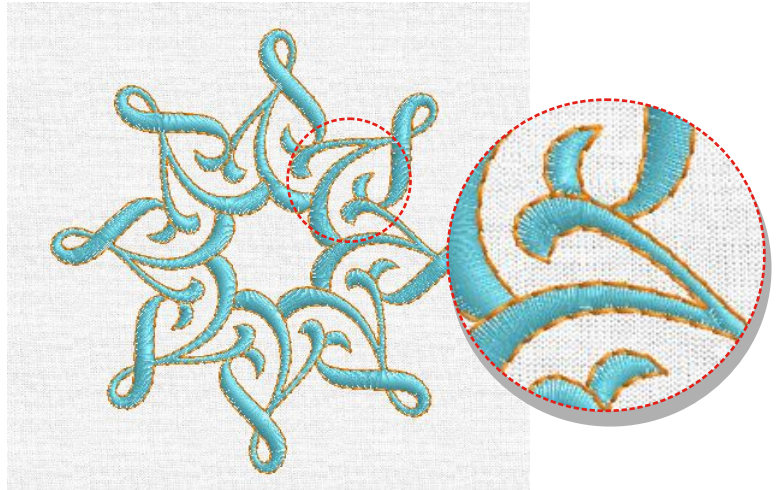

8. You should end up with a design like this!
Click the **stitch** tab to see the arabesque in stitches!!

9. Notice that in some areas, parts of the arabesque overlap each other. This overlapping is going to create problems in the quality of the embroidery in general, due to the thread thickness. This will cause padding out in these parts where the arabesque symbols overlap. To fix that...

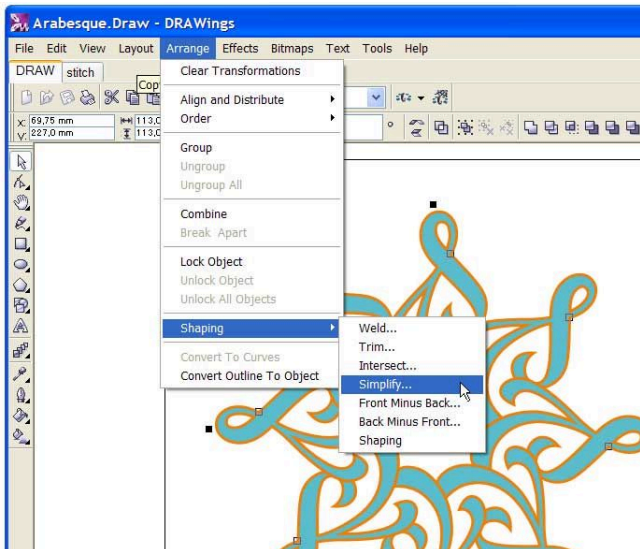

10. Turn back to **DRAW** and select all the parts of the arabesque and from the **Arrange** Menu click **Shaping** and then **Simplify...**

11. This is how **Simplify** works; It trims out the overlapping parts of a design.

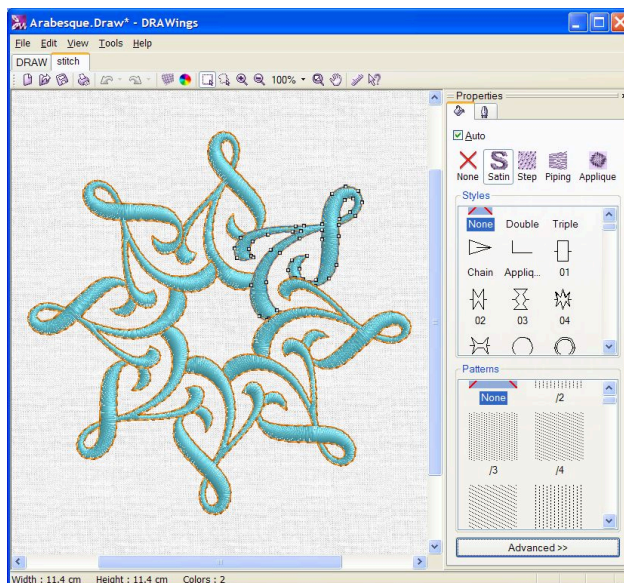

12. This is the final arabesque as shown in **DRAWings**

Visit www.drawstitch.com for more examples of embroidery features.